

Simple Medical(Shenzhen)Limited
Instruction For Use

SIMPLE Shoulder Abduction Immobilizer E6

Model: 31004 Size: F

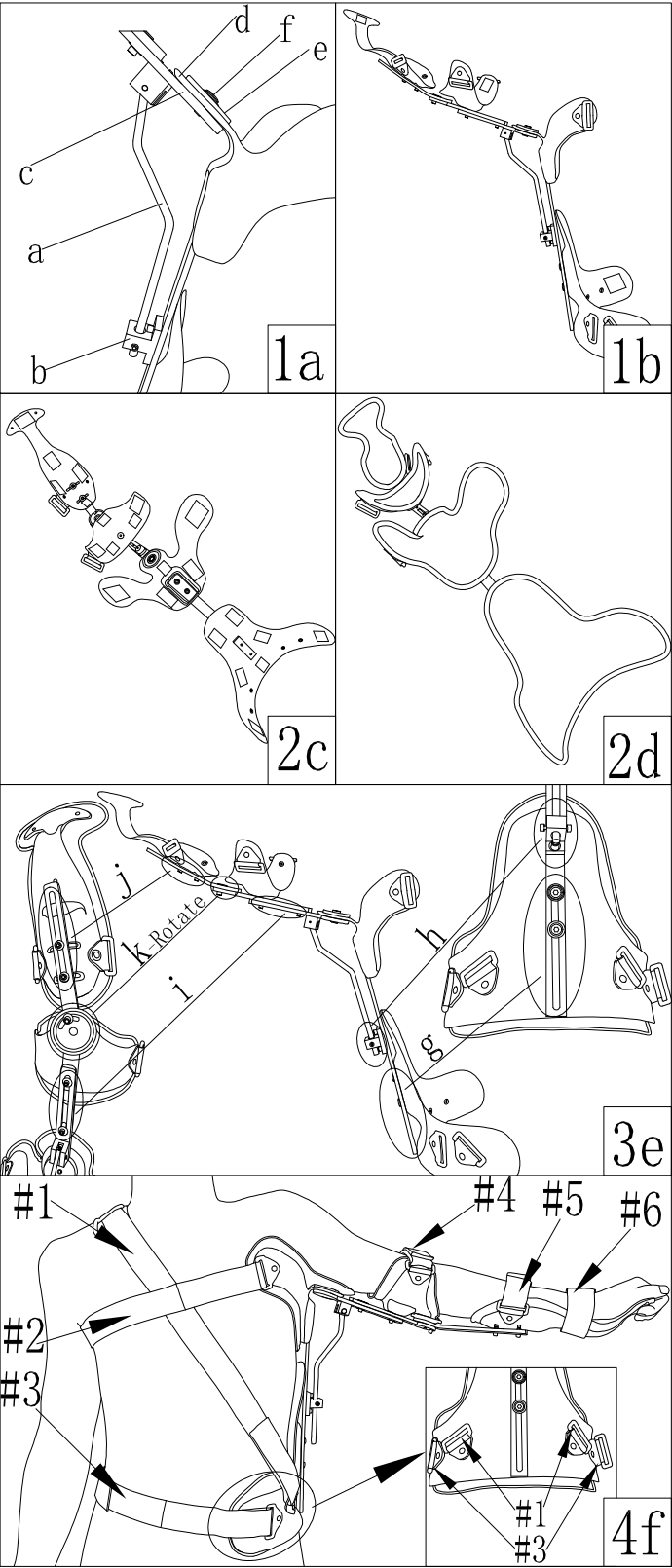

Thank you for purchasing our products! Please read this instruction carefully before operation! To fully understand the product, in order to ensure the safety and effectiveness of the product, and please properly save the manual for future reference

Product overview

- 1)Product name: SIMPLE Shoulder Abduction Immobilizer E6
- 2)Product model: 31004
- 3)Product specification: F
- 4)Product Structure:

The shoulder Brace is mainly composed of metal support, metal adjusting rod, plastic bracket, strap, liner and accessories.

5)Operating principle: The product adopts lightweight design, easy to use and comfortable to wear. The product has good fixing effect, adjustable arm height, length and elbow flexion and extension, comfortable and breathable gasket, so that the patient can achieve better recovery effect.

6)Scope of application

external use for shoulder joint postoperative fixation, humeral fracture with radial nerve injury, deltoid muscle paralysis, supraspinatus tendon rupture, shoulder fracture, posterior brachial plexus paralysis, acute shoulder peri arthritis, shoulder suppurative arthritis, and shoulder tuberculosis.

Product features and performance description

1) Product features and storage conditions

【 Product features 】 The product is simple and can be applied topically to patients with plantar fasciitis and pain

【 Storage conditions 】 This product should be stored in a room with no more than 80% relative humidity, no corrosive gas and good ventilation to avoid high temperature

2) Using the operating

【Application Instructions】

STEP 1: Install the bracket. Unscrew the bracing circular retainer (c & e) of the bracelet chain and put the height adjusting rod (a) into the inside of the adjusting seat (b), Then fix the circular fixture of the arm on the shoulder plastic bracket (d) Use the screw (f) to lock (Fig1a~1b).

STEP 2: Install the liners. Install the liner in the appropriate position (Fig2c~2d).

STEP 3: Adjust the brace (Fig 3c). Place the shoulder support at a point under the armpit and fix it with your hands.

A) Adjust the height of the waist bracket (g) to the waist.

B) Then adjust the height adjusting rod (a), according to the patient's needs and tighten the screws on both sides of the adjusting seat with tools so that the adjusting rod is fixed to the (h).

C) Adjust the length of the bracelet chain (j &i) and then tighten the adjusting screws to ensure the safe use of the braces.

D) Adjust the flexion and extension angle of elbow (k-Rotate).

STEP 4: Fasten the straps. When fixing the straps, the retainer should maintain a supporting state to prevent the brace from moving. First put the binding sleeve on the strap # 1 (longest).

Fasten the straps through the strap buckle, magic fasten around each part of the strap and fasten it through another strap buckle (Fig. 4F).

The order of straps is as follows:

Strap# 1: Tie the shoulder and fix the brace..

Strap # 2: Fasten the upper body.

Strap # 3: Fasten the waist.

Strap # 4: Fasten your elbows.

Strap # 5: Fasten the middle of the wrist and elbow.

Strap # 6: Fasten your wrists.

Maintenance:

Lining can use neutral detergent and 30 ℃ water washed by hand, and natural dry. Do not use clothes dryer or other heat source for drying. Salt water, sand, dirt and other elements can cause damage .After exposure to these conditions, rinse thoroughly with water, dry with a towel or air dry (do not machine dry).If you need detergent, please use mild detergent, do not use softener and bleach.

Warning:

If you experience pain, swelling, irritation, or discomfort while using this product, discontinue use and consult your doctor.

*This product is for support only and is not intended to prevent injury or to prevent the recurrence of injuries.

Basic product environment

- 1) Ambient temperature: -15 ~ 60 ℃
- 2) Relative humidity: 80%

Product material

- 1) Plastic bracket: polypropylene
- 2) Metal support: aluminum alloy
- 3) Liners: nylon / PU
- 4) Strap: nylon

Contraindication

- ⚠ Do not use in case of allergy;
- ⚠ Those with unknown skin masses are forbidden;
- ⚠ Those with swollen or ulcerated skin are forbidden;

Storage, transportation and expiry date of products

- 1)Product is valid: Three years
- 2)Product storage: Please place it in a dry and clean room before use to ensure ventilation
- 3)Transportation: the product shall be dustproof, moisture-proof and pollution-proof during storage and transportation

Disposal of wastes

Disposal of wrapping paper (bags): please dispose of the packaging of this product according to the local laws.

Symbol and picture description

- Manufacture Date
- Batch Code
- medical device
- CE Symbol
- Hand wash only
- Protect from sunlight
- Do not use when the packing is damaged
- Warnings and Precautions
- It is valid for three years
- Reference instructions

Accessories list

- Instructions ----- 1 copy
- Large hexagonal wrench ----- 1 PCS
- Small hexagonal wrench ----- 1 PCS
- Strap sleeve ----- 1PCS
- Liners ----- 5 PCS (sets)
- Straps----- 6 PCS (sets)

After-sales warranty

If there is any defect in the material or process of the product, please contact your vendor directly, and the Simple medical will repair or replace the product.

Simple Medical (Shenzhen) Limited
Address: 519 Wisdom Valley, No.1010 Bulong Road, Minzhi Street,Longhua District, Shenzhen, China.518131
Tel : +86-755-86038563
Web: www.simplemedical.cn
E-mail: service@simplegroup.net

EC REP
SUNGO Europe B.V.

Fascinatia Boulevard 522 ,Unit1.7,2909VA Capelle aan den IJssel ,The Netherlands
Tel : +31(0)10-3034500
***Please refer to the Instructions before usage.**

